

## Optical Component Catalog

*OEM and Prototype Manufacturing*

www.optisourcellc.com / sales@optisourcellc.com Ph:505-792-0277 / Fax:505-792-0281



### **Waveplates**

- Crystal Quartz
- Mica

### **Windows**

- Parallel
- Wedged
- Square / Rectangular

### **Mirrors**

- Dielectric
- Metal
- Plano
- Spherical

### **Lenses**

### **Prisms**

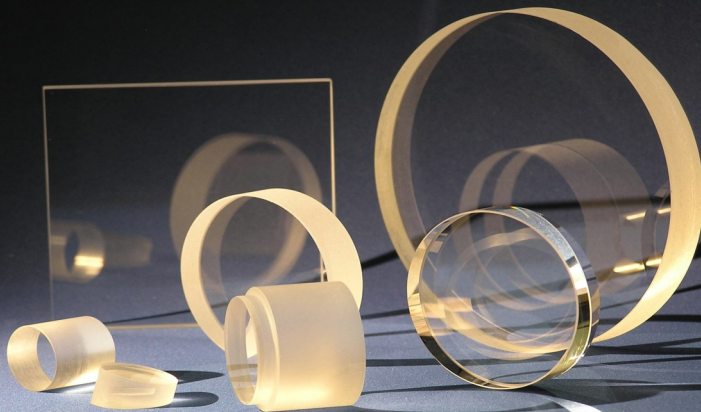
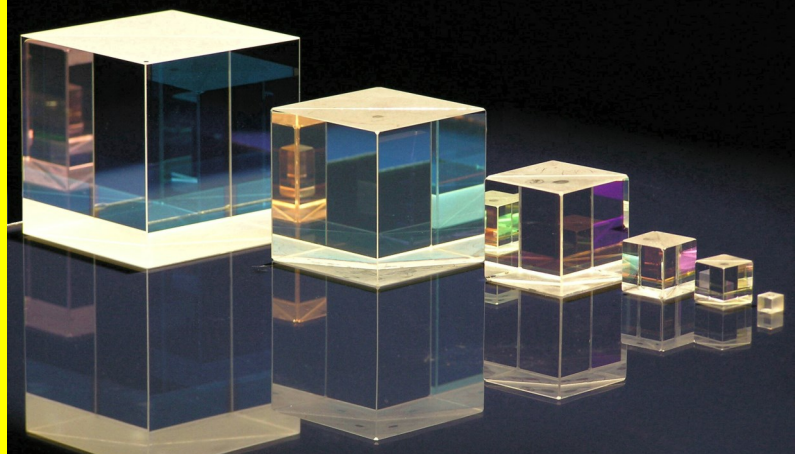

### **Beamsplitters**

- Cube
- Plate

### **Polarizers**

- Cube
- Plate



---

## Welcome to OptiSource, LLC

### ***A letter from our GM***

***We appreciate the opportunity to showcase our products for you and look forward to providing the solution to your component needs.***

After familiarizing yourself with our services and product offerings, we hope your next step will be to place an order with our company. We believe you will become another of a growing number of satisfied customers partnering with OptiSource, LLC, currently in our second decade of operations.

OptiSource, LLC is a small manufacturer of prototype and OEM quantities of optical components. Because of our size, we are able to incorporate many of the advantages and amenities associated with a larger company (i.e. a wide array of in-stock inventory) without the downside of dealing with the bureaucracies inherent in big companies.

The OptiSource staff is knowledgeable—150+ years of experience in all facets of sales, coating, fabrication and assembly of precision optical components.

Our smaller size affords us the advantage of maintaining a low overhead. Low overhead plus a skilled staff that multi-tasks, equals significant cost savings that we pass along to our customers.

We have developed a level of flexibility in our manufacturing environment not usually found in a larger company. This flexibility allows our manufacturing team to respond to your individual needs more effectively while still maintaining our OEM schedules.

As a user or buyer, you talk directly to the people who know the status of your order. They will give you a prompt assessment of your order status.

Having the components to successfully complete your project(s) and deliver your product is a direct measure of our performance. Place your order. Give us a chance to partner with you. You'll be convinced of our commitment to your success.

Thank you,

Greg Woodhouse  
General Manager  
OptiSource, LLC

# Plane Windows

**Product Code: PW**

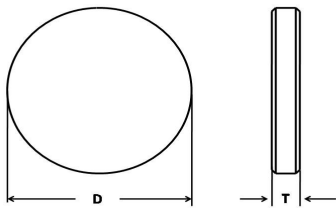

Substrate Materials: UV Fused Silica, BK-7  
 Diameter Tolerance: +0.000 /-0.010" [+0.00/-0.25mm]  
 Thickness Tolerance: +/-0.010" [+/-0.25mm]  
 Surface Quality: 10-5 Per ANSI/OESC OP1.002-2006  
 Parallelism: ≤ 5 arc minutes  
 Chamfer: 0.38mm @ 45° typical  
 Clear Aperture: ≥ central 85% of diameter

- OptiSource Plane Windows (PW) are available as coated or uncoated optics.
- To select a coating, please see our coating offerings beginning on catalog page 36.
- Non-standard substrates are also available, but require a quotation for price and delivery. Please contact OptiSource, LLC Technical Sales for all of your non-standard requirements.

Part Number	Diameter (mm) "D"	Thickness (mm) "T"	Surface Figure	Surface Quality	Substrate Material
PW-0512-XX	12.70	3.18	$\lambda/10$ @ 633nm	10-5	UV,BK-7
PW-0525-XX	12.70	6.35	$\lambda/10$ @ 633nm	10-5	UV,BK-7
PW-0537-XX	12.70	9.53	$\lambda/10$ @ 633nm	10-5	UV,BK-7
PW-1004-XX	25.40	1.00	$\lambda/4$ @ 633nm	10-5	UV,BK-7
PW-1012-XX	25.40	3.18	$\lambda/4$ @ 633nm	10-5	UV,BK-7
PW-1025-XX	25.40	6.35	$\lambda/10$ @ 633nm	10-5	UV,BK-7
PW-1037-XX	25.40	9.53	$\lambda/10$ @ 633nm	10-5	UV,BK-7
PW-1525-XX	38.10	6.35	$\lambda/10$ @ 633nm	10-5	UV,BK-7
PW-1537-XX	38.10	9.53	$\lambda/10$ @ 633nm	10-5	UV,BK-7
PW-2025-XX	50.80	6.35	$\lambda/10$ @ 633nm	10-5	UV,BK-7
PW-2037-XX	50.80	9.53	$\lambda/10$ @ 633nm	10-5	UV,BK-7
PW-3037-XX	76.20	9.53	$\lambda/10$ @ 633nm	10-5	UV,BK-7
PW-3050-XX	76.20	12.70	$\lambda/10$ @ 633nm	10-5	UV,BK-7
PW-4050-XX	101.60	12.70	$\lambda/10$ @ 633nm	10-5	UV,BK-7

# Plane Parallel Windows

**Product Code: PW1**

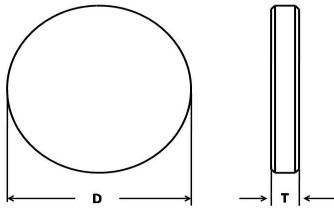

Substrate Materials: UV Fused Silica, BK-7  
 Diameter Tolerance: +0.000 /-0.010" [+0.00/-0.25mm]  
 Thickness Tolerance: +/-0.010" [+/-0.25mm]  
 Surface Quality: 10-5 Per ANSI/OESC OP1.002-2006  
 Parallelism: ≤ 10 arc seconds  
 Chamfer: 0.38mm @ 45° typical  
 Clear Aperture: ≥ central 85% of diameter

- OptiSource Plane Parallel Windows (PW1) are available as coated or uncoated optics.
- To select a coating, please see our coating offerings beginning on catalog page 36.
- Non-standard substrates are also available, but require a quotation for price and delivery. Please contact OptiSource, LLC Technical Sales for all of your non-standard requirements.

Part Number	Diameter (mm) "D"	Thickness (mm) "T"	Surface Figure	Surface Quality	Substrate Material
PW1-0525-XX	12.70	6.35	$\lambda/10$ @ 633nm	10-5	UV,BK-7
PW1-0537-XX	12.70	9.53	$\lambda/10$ @ 633nm	10-5	UV,BK-7
PW1-1012-XX	25.40	3.18	$\lambda/10$ @ 633nm	10-5	UV,BK-7
PW1-1025-XX	25.40	6.35	$\lambda/10$ @ 633nm	10-5	UV,BK-7
PW1-1037-XX	25.40	9.53	$\lambda/10$ @ 633nm	10-5	UV,BK-7
PW1-1525-XX	38.10	6.35	$\lambda/10$ @ 633nm	10-5	UV,BK-7
PW1-1537-XX	38.10	9.53	$\lambda/10$ @ 633nm	10-5	UV,BK-7
PW1-2025-XX	50.80	6.35	$\lambda/10$ @ 633nm	10-5	UV,BK-7
PW1-2037-XX	50.80	9.53	$\lambda/10$ @ 633nm	10-5	UV,BK-7
PW1-3037-XX	76.20	9.53	$\lambda/10$ @ 633nm	10-5	UV,BK-7
PW1-3050-XX	76.20	12.70	$\lambda/10$ @ 633nm	10-5	UV,BK-7
PW1-4050-XX	101.60	12.70	$\lambda/10$ @ 633nm	10-5	UV,BK-7

# Wedged Windows

Product Code: IF / LW

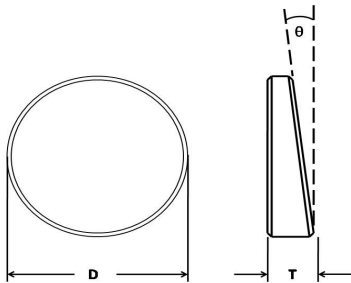

Substrate Materials: UV Fused Silica, BK-7  
 Diameter Tolerance: +0.000 /-0.010" [+0.00/-0.25mm]  
 Thickness Tolerance: +/-0.010" [+/-0.25mm]  
 Surface Quality: 10-5 Per ANSI/OESC OP1.002-2006  
 Wedge Tolerance: +/- 5 arc minutes  
 Chamfer: 0.38mm @ 45° typical  
 Clear Aperture: ≥ central 85% of diameter

- OptiSource Interferometer Flats (IF) and Large Wedges (LW) are available as coated or uncoated optics.
- To select a coating, please see our coating offerings beginning on catalog page 36.
- Non-standard substrates are also available, but require a quotation for price and delivery. Please contact OptiSource, LLC Technical Sales for all of your non-standard requirements.

## Interferometer Flats — Product Code: IF

Part Number	Diameter (mm) "D"	Thickness (mm) "T"	Wedge	Surface Figure	Surface Quality	Substrate Material
IF-1025-XX	25.40	6.35	30'	$\lambda/10$ @ 633nm	10-5	UV,BK-7
IF-1037-XX	25.40	9.53	30'	$\lambda/10$ @ 633nm	10-5	UV,BK-7
IF-2025-XX	50.80	6.35	30'	$\lambda/10$ @ 633nm	10-5	UV,BK-7
IF-2037-XX	50.80	9.53	30'	$\lambda/10$ @ 633nm	10-5	UV,BK-7
IF-3050-XX	76.20	12.70	30'	$\lambda/10$ @ 633nm	10-5	UV,BK-7
IF-4050-XX	101.60	12.70	30'	$\lambda/10$ @ 633nm	10-5	UV,BK-7

## Large Wedged Windows — Product Code: LW

Part Number	Diameter (mm) "D"	Thickness (mm) "T"	Wedge	Surface Figure	Surface Quality	Substrate Material
LW-X-1025-XX	25.40	6.35	1°, 2°, 3°	$\lambda/10$ @ 633nm	10-5	UV,BK-7
LW-X-1037-XX	25.40	9.53	1°, 2°, 3°	$\lambda/10$ @ 633nm	10-5	UV,BK-7
LW-X-2037-XX	50.80	9.53	1°, 2°, 3°	$\lambda/10$ @ 633nm	10-5	UV,BK-7
LW-X-3050-XX	76.20	12.70	1°, 2°, 3°	$\lambda/10$ @ 633nm	10-5	UV,BK-7

\*Please specify the amount of wedge in degrees when ordering a Large Wedge Window –i.e. LW-3-1037-UV would indicate a 1.00"Ø x 0.375" fused silica window with a wedge of 3 degrees.

# Square / Rectangular Windows

**Product Code: SQW / RW**

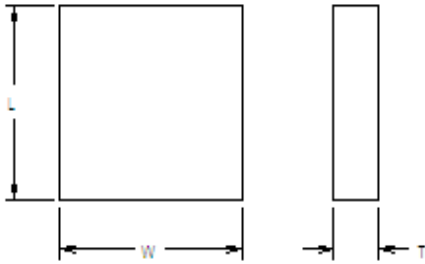

Substrate Materials: UV Fused Silica, BK-7  
 Dimension Tolerance: +0.000 /-0.010" [+0.00/-0.25mm]  
 Thickness Tolerance: +/-0.010" [+/-0.25mm]  
 Surface Quality: 10-5 Per ANSI/OESC OP1.002-2006  
 Parallelism: ≤ 5 arc minutes  
 Chamfer: 0.38mm @ 45° typical  
 Clear Aperture: ≥ central 85% of diameter

- OptiSource Square (SQW) / Rectangular (RW) are available as coated or uncoated optics.
- To select a coating, please see our coating offerings beginning on catalog page 36.
- Non-standard substrates are also available, but require a quotation for price and delivery. Please contact OptiSource, LLC Technical Sales for all of your non-standard requirements.

## Square Windows — Product Code: SQW

Part Number	Length (mm) "L"	Width (mm) "W"	Thickness (mm) "T"	Surface Figure	Surface Quality	Substrate Material
SQW-0525-XX	12.70	12.70	6.35	λ/10 @ 633nm	10-5	UV,BK-7
SQW-1025-XX	25.40	25.40	6.35	λ/10 @ 633nm	10-5	UV,BK-7
SQW-1037-XX	25.40	25.40	9.53	λ/10 @ 633nm	10-5	UV,BK-7
SQW-2037-XX	50.80	50.80	9.53	λ/10 @ 633nm	10-5	UV,BK-7

## Rectangular Windows — Product Code: RW

Part Number	Length (mm) "L"	Width (mm) "W"	Thickness (mm) "T"	Surface Figure	Surface Quality	Substrate Material
RW-28.6-14.3-3.18-XX	28.60	14.30	3.18	λ/4 @ 633nm	10-5	UV,BK-7
RW-40.0-30.0-5.00-XX	40.00	30.00	5.00	λ/10 @ 633nm	10-5	UV,BK-7